



ERCO HC4502
ERCO HC5502

C-Line

Lifting equipment



4500



5500



Electro-hydraulic two post lifts with top connections
Possibility of installation in symmetrical or asymmetric version



ERCO HC4502 - ERCO HC5502

Electro-hydraulic two post lifts with top connections. Possibility of installation in **symmetrical** or **asymmetric** version. Realignment of the two carriages using metal cables that guarantee excellent synchronisation.

Standard height of two-post connection: 4,050 mm.

Available versions (with optional column extension set):

- **V**: Specific for vans (Height of two-post connection: 4,620 mm).
- **XV**: Specific for vans and very high vehicles, extra-high version (Height of two-post connection: 5,220 mm).

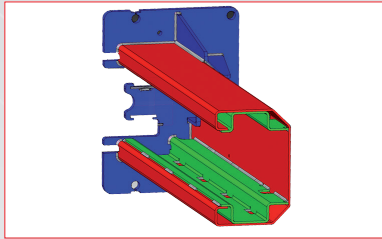

- **Internally reinforced column structure** for little bending and internal cable guiding.

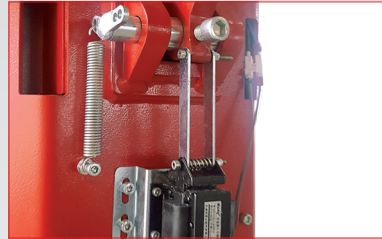

- **Electro magnet safety release 24V.**



- **Rubber door protections. Toothed sector arm rotation stop system.**

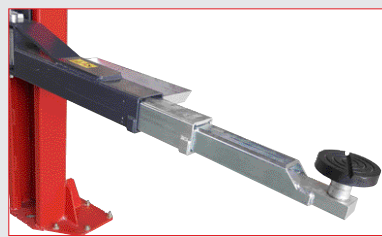

- **Four three-section symmetrical arms.**

SUPPLIED ACCESSORIES

- Safety stop-bar included as standard.
- Two set of extension pads.

OPTIONAL

- Column extension set
- 8-43300021 Set of 4 extension for pads, H=35 mm
- 8-43300014 Set of 4 extension for pads, H=80 mm
- 8-43300015 Set of 4 extension for pads, H=140 mm
- 8-43300016 Set of 4 adapters for Mercedes Sprinter



TECHNICAL DATA

Model	Lift capacity	Lifting time	Three phase motor	Single phase motor	Max. lifting height	Max. locking position	Lift minimum height	Height connection
ERCO HC4502	4500 kg	45 s	400/230V - 3kW	230V - 3kW	2062 mm	1957-2037 mm	115 mm	4050 / 4620 /
ERCO HC5502	5500 kg		3ph - 50 /60 Hz	1ph - 50 /60 Hz				

OVERALL DIMENSIONS

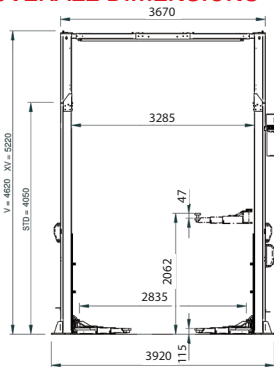

Symmetric Installation ERCO HC4502

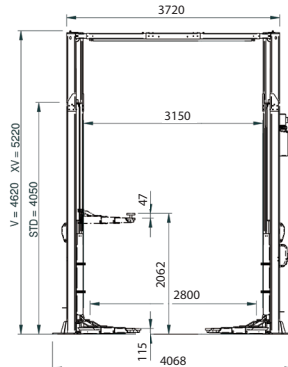
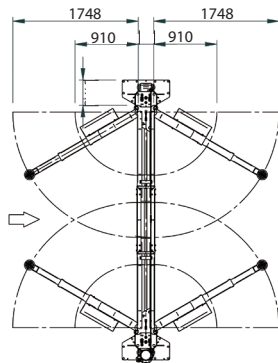

Asymmetric Installation ERCO HC5502

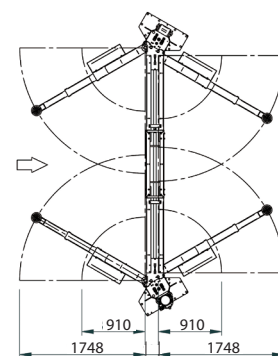

NEXION SPA - www.corghi.com - info@corghi.com



Designed in
ITALY

